



Maintenance Hole Chambers

(BS EN 13598 Compliant)

About Edoburg

Edoburg is a structured, multi-category global supplier of certified infrastructure materials, serving contractors, distributors, and institutional buyers across regulated global markets. A division of **Edoburg Downes Pvt. Ltd.**, the company operates with a clear focus on tested quality, export compliance, and long-term delivery consistency.

Our product portfolio spans over 10,000 SKUs across a wide range of categories including plastic piping systems, thermoplastic and composite pipelines, metal pipes and sections, drainage and utility systems, industrial components, and specialized engineered solutions for global projects.

All Edoburg-supplied products are manufactured in audited facilities and conform to international standards such as ASTM, CSA, ISO, IS, AS/NZS, and EN, depending on the target market. Each order is backed by full documentation support — including batch test reports, packing lists, Certificates of Origin, and private labelling when required.

We operate with export-ready processes, offering mixed container loads, low or no minimum order quantity, and market-specific packaging and compliance labelling. Our systems are designed to meet the expectations of professional buyers who require traceability, repeatability, and standardization across multiple geographies.

With clients across North America, Europe, the Middle East, Africa, and Asia-Pacific, Edoburg is positioned as a dependable global supplier — combining technical competence with structured commercial execution.

We don't just deliver material. **We supply what builds.**

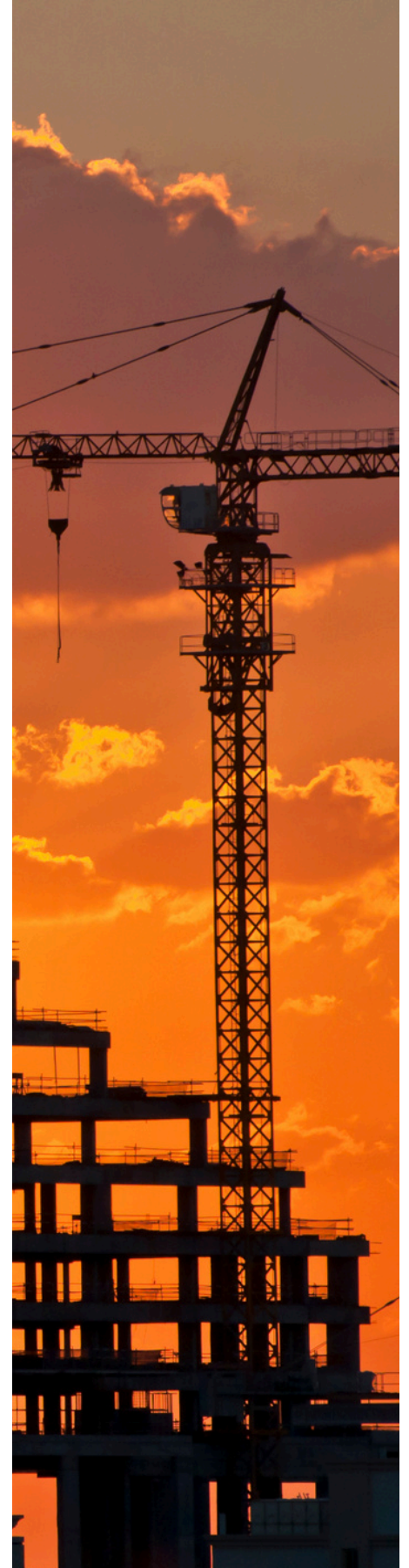

EDOBURG

SUPPLY WHAT BUILDS



Properties and Technical Sheet

Maintenance Hole Chambers Systems

Manhole and Inspection Chambers are made from PE (Polyethylene) material. Polyethylene material is resistant to acids, bases and organic compounds, thus Manhole and Inspection Chambers can withstand aggressive substances like sulphuric acid and hydrogen sulphide which are found in every sewer.

These are integral to underground drainage systems and are installed where multiple drainage lines are connected. It is used for inspection, maintenance and removal of debris which is generated through the flow of sewer waste. These are used in sewerage/drainage networks. For maintenance of sewer manhole entry diameter were maintained for person entry and steps were provided to reach the person safely to base of the Manhole chamber.

Standard:

- BS EN 13598 1 & 2

Manufacturing Origin: India

Manhole Part	Total Height (mm)	Effective Height / Invert Depth (mm)
Base	750	700
Riser	580	510
	315	250
Cone	1180	1110
	1330	1260
	1480	1410

Features and benefits

- Socket, spigot and side inlet connections with rubber sealing ring.
- Resistant to floating due to ribs and collar provided on external surface of riser/shaft.
- Abrasion resistant.
- Smooth inside invert surface for high hydraulic capacity.
- Chemical resistant.
- About 2° slope provided for gravity flow in Inspection Chamber base.
- Light weight.

Dimensions of Maintenance Hole Chambers

Item description	Main Inlet	Side Inlet	Main Outlet
1000mm Base , 3Inlets and 1Multi outlet suitable for UPVC pipes	110, 160, 200, 250 & 315mm.	110, 160, 200, 250 & 315mm.	200, 250 & 315mm. 110mm, 160 & 200mm.
1000mm Base , 2Inlets and 2Multi outlet suitable for UPVC pipes	200, 250 & 315mm.	110, 160, 200, 250 & 315mm.	200, 250 & 315mm. 110mm, 160 & 200mm.
1000mm Base , 3Inlets and 1 outlet suitable for DWC pipes	250 & 300mm	100, 150 & 200mm*	250 & 300mm

Product Image



Type of Manhole Base

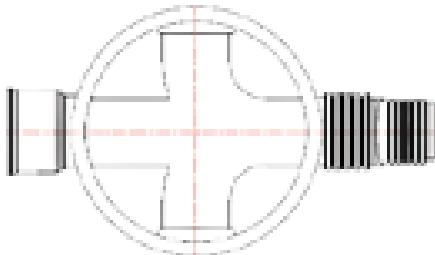
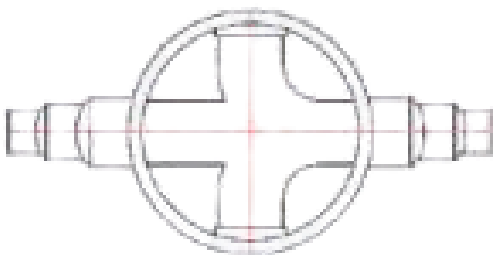
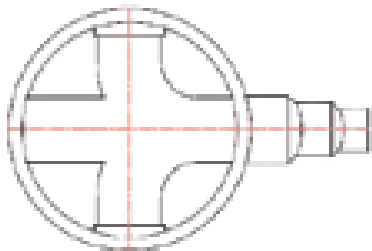

Handling and Storage

Proper Handling



- **Impact Prevention:** Avoid dropping, dragging, or throwing pipes during handling. Sudden impact may cause stress fractures or joint damage.
- **Lifting Guidelines:** Use padded pipe tongs, wide slings, or fork protectors. Chains, hooks, or bare forks may gouge or scar the pipe surface.
- **Inspection on Delivery:** Check all pipes and fittings on arrival for cracks, warping, or joint-end damage due to transit or handling.

Storage

Pipes and Fittings must be stored in a dry, shaded, and well-ventilated location. If outdoor storage is unavoidable, the following best practices must be observed to maintain product performance and installation safety:



- **UV Protection:** Shield from direct sunlight using UV-resistant tarpaulin or sheeting. Ensure ventilation is maintained to prevent heat buildup.
- **Flat Surface Storage:** Pipes must rest on a flat, stable surface. Uneven storage areas may lead to sagging, ovality, or misalignment of sockets.
- **Stacking Alignment:** When stacking, alternate spigot and socket ends to distribute load evenly and avoid deformation of socket geometry.
- **Stacking Height Limit:** Do not exceed recommended stack heights. Excessive weight can distort pipe roundness and compromise sealing surfaces.
- **Rack Spacing:** When using pipe racks, provide support at intervals of not more than 900 mm (3 ft) to prevent bending or bowing.
- **Inspection on Delivery:** Inspect all pipes and fittings immediately upon receipt. Check for any damage, deformation, or cracks—especially at the joint ends.

Note: Improper handling may affect joint integrity and project safety. Always follow local code.



Division of Edoburg Downes Pvt. Ltd.

www.edoburg.com



We don't just deliver material. We supply what builds.

Global RFQ Desk

E: rfq@edoburg.com

India

Global Infrastructure Supply Division

E: global@edoburg.com

M: +91 928 966 8883

Australia

Oceania Coordination Desk

E: oceania@edoburg.com

M: +61 4 1030 4720

Estonia

EU Coordination Desk

E: eu@edoburg.com

Disclaimer: All information in this catalogue is provided in good faith and reflects the best knowledge of Edoburg Downes Pvt. Ltd. and its division Edoburg at the time of publication. Edoburg does not manufacture the products listed but supplies them through certified and audited partners. Product specifications, certifications, availability, and compliance may vary by region and application. Buyers are responsible for verifying local suitability and regulatory requirements before use. Images and layouts are for representation only and may differ from the final product. Edoburg reserves the right to update content without notice. All disputes are subject to the jurisdiction of the courts of India.